

VN-Winder HT



Axial fans for smoke exhaust

The information below covers the standard range. The possibilities are extensive and besides the diameter of the impeller and speed, also the fan can be configured by different types of impellers, the angle of the impeller and the motor power.

| | |
|------------------|--|
| Sizes | 300 up to 1.600 mm |
| Motor (standard) | HT motor IP55, 230/1/50 or 400/3/50 |
| Capacity | up to 190.000 m ³ /hr |
| Pressure | up to 1.450 Pa |
| Control | Frequency converter |
| Casing | Steel galvanized |
| Impeller | Aluminum (special high performance geometry) |
| Extra | Suitable for high temperatures up to 200°C , 300°C or 400°C for 120 minutes (F200, F300 or F400). The fans are suitable for smoke exhaust and are certificated following EN 12101-3:2015. |
| Atex |  Gas : zone 1 II2G and 2 II3G Dust on request: zone 21 II2D and 22 II3D |
| Accessories | Inlet cone / Silencers / Protection grid / Shutters / Inspection window / Flexible connections / Anti-vibration mounts / Support feet / Flanges / Switches/ Terminal box / Frequency converters |

2 pole (3.000 rpm.) – 400/3/50

| Model | Capacity max. (m ³ /h) | 100 Pa m ³ /h | 200 Pa m ³ /h | 400 Pa m ³ /h | Pressure max. (Pa static) | Motor (kW) | In max. (A) |
|---------|--------------------------------------|-----------------------------|-----------------------------|-----------------------------|------------------------------|---------------|----------------|
| 312/A T | 4.010 | 3.550 | 2.800 | - | 260 | 0,75 | 1,57 |
| 312/B T | 4.500 | 4.200 | 3.500 | - | 250 | 1,1 | 2,32 |
| 352/A T | 3.500 | 4.500 | 3.800 | - | 340 | 0,75 | 1,57 |
| 352/B T | 7.850 | 7.400 | 6.600 | - | 310 | 1,5 | 3,01 |
| 402/A T | 5.500 | 5.200 | 4.800 | 3.300 | 450 | 1,1 | 2,32 |
| 402/D T | 11.700 | 11.100 | 10.300 | 7.900 | 460 | 3 | 6 |
| 452/A T | 7.485 | 7.100 | 6.700 | 5.500 | 600 | 1,1 | 2,32 |
| 452/D T | 15.650 | 15.000 | 14.000 | 11.800 | 560 | 4 | 7,5 |
| 562/B T | 24.600 | 23.000 | 22.500 | 21.000 | 1.350 | 5,5 | 10,6 |
| 562/C T | 27.970 | 26.500 | 26.000 | 23.000 | 1.400 | 7,5 | 14,2 |

4 pole (1.500 rpm.) – 400/3/50

| Model | Capacity max. (m ³ /h) | 200 Pa m ³ /h | 400 Pa m ³ /h | 600 Pa m ³ /h | Pressure max. (Pa static) | Motor (kW) | In max. (A) |
|----------|--------------------------------------|-----------------------------|-----------------------------|-----------------------------|------------------------------|---------------|----------------|
| 404 T | 5.900 | - | - | - | 110 | 0,55 | 1,36 |
| 454 T | 7.300 | - | - | - | 140 | 0,55 | 1,36 |
| 504/A T | 7.420 | - | - | - | 120 | 0,55 | 1,36 |
| 504/B T | 11.830 | - | - | - | 150 | 0,75 | 1,85 |
| 564/B T | 12.300 | 7.900 | - | - | 330 | 0,75 | 1,85 |
| 564/C T | 14.000 | 9.200 | - | - | 350 | 1,1 | 2,44 |
| 634/B T | 17.100 | 12.000 | - | - | 350 | 1,1 | 2,44 |
| 634/C T | 18.700 | 13.500 | - | - | 340 | 1,5 | 3,29 |
| 714/B T | 19.550 | 13.000 | 5.500 | - | 460 | 1,5 | 3,29 |
| 714/C T | 23.720 | 18.000 | - | - | 300 | 2,2 | 4,64 |
| 804/B T | 33.950 | 28.500 | 14.500 | - | 470 | 4 | 7,69 |
| 804/C T | 37.220 | 32.500 | 23.500 | - | 460 | 5,5 | 10,6 |
| 904/B T | 42.210 | 36.100 | 24.000 | 14.400 | 710 | 5,5 | 10,6 |
| 904/C T | 49.200 | 42.900 | 32.800 | 18.600 | 735 | 7,5 | 14,2 |
| 1004/B T | 62.600 | 56.000 | 48.000 | 34.000 | 910 | 11 | 21,5 |
| 1004/C T | 75.500 | 69.800 | 62.000 | 49.500 | 900 | 15 | 29,0 |
| 1254/B T | 110.950 | 103.000 | 91.500 | 77.000 | 1000 | 22 | 41,7 |
| 1254/C T | 129.270 | 121.900 | 112.400 | 100.000 | 920 | 30 | 54,8 |
| 1254/D T | 134.450 | 129.100 | 119.600 | 107.300 | 920 | 37 | 66,8 |
| 1254/E T | 152.000 | 145.100 | 139.000 | 129.100 | 850 | 45 | 79,9 |
| 1404/A T | 130.000 | 120.000 | 110.000 | 95.000 | 860 | 30 | 54,8 |
| 1404/B T | 181.620 | 170.100 | 162.500 | 153.000 | 920 | 55 | 78,8 |
| 1404/C T | 188.885 | 177.000 | 168.800 | 160.100 | 920 | 75 | 129,1 |

6 pole (1.000 rpm.) – 400/3/50

| Model | Capacity max. (m ³ /h) | 100 Pa m ³ /h | 200 Pa m ³ /h | 400 Pa m ³ /h | Pressure max. (Pa static) | Motor (kW) | In max. (A) |
|----------|--------------------------------------|-----------------------------|-----------------------------|-----------------------------|------------------------------|---------------|----------------|
| 506 T | 6.500 | - | - | - | 80 | 0,55 | 1,61 |
| 566/B T | 8.120 | 4.600 | - | - | 150 | 0,25 | 0,70 |
| 566/C T | 9.230 | 5.500 | - | - | 160 | 0,37 | 1,11 |
| 636/B T | 11.600 | 7.100 | - | - | 160 | 0,37 | 1,11 |
| 636/C T | 12.385 | 8.400 | - | - | 150 | 0,55 | 1,36 |
| 716/B T | 12.900 | 8.000 | 2.500 | - | 200 | 1,5 | 3,29 |
| 716/C T | 15.650 | 11.250 | - | - | 135 | 0,75 | 1,85 |
| 806/B T | 23.560 | 19.000 | 8.000 | - | 210 | 1,5 | 3,29 |
| 806/C T | 27.290 | 23.000 | 14.000 | - | 200 | 2,2 | 4,64 |
| 906/B T | 27.860 | 23.000 | 14.000 | - | 310 | 1,5 | 3,29 |
| 906/C T | 32.465 | 27.500 | 19.800 | - | 330 | 2,2 | 4,64 |
| 1006/B T | 41.320 | 36.000 | 30.000 | - | 390 | 3 | 6,47 |
| 1006/C T | 45.960 | 41.000 | 35.000 | 18.000 | 480 | 4 | 7,69 |
| 1006/D T | 49.830 | 45.000 | 40.000 | - | 390 | 5,5 | 10,6 |
| 1256/A T | 61.115 | 57.000 | 48.000 | 25.000 | 480 | 5,5 | 10,6 |
| 1256/B T | 73.210 | 69.000 | 58.000 | 35.000 | 600 | 7,5 | 14,2 |
| 1256/C T | 85.320 | 81.000 | 72.000 | 50.000 | 610 | 11 | 21,5 |
| 1406/A T | 86.730 | 80.000 | 70.000 | 48.000 | 600 | 11 | 21,5 |
| 1406/B T | 121.100 | 115.000 | 108.000 | 86.000 | 790 | 18,5 | 35,7 |
| 1406/C T | 125.920 | 120.000 | 112.000 | 93.000 | 880 | 22 | 41,7 |
| 1606/A T | 129.530 | 120.000 | 112.500 | 88.000 | 780 | 18,5 | 35,7 |
| 1606/B T | 155.170 | 147.000 | 135.000 | 114.000 | 1000 | 22 | 41,7 |
| 1606/C T | 180.830 | 171.000 | 165.000 | 140.000 | 1000 | 30 | 54,8 |

8 pole (750 rpm.) – 400/3/50

| Model | Capacity max. (m ³ /h) | 100 Pa m ³ /h | 200 Pa m ³ /h | 400 Pa m ³ /h | Pressure max. (Pa static) | Motor (kW) | In max. (A) |
|------------|--------------------------------------|-----------------------------|-----------------------------|-----------------------------|------------------------------|---------------|----------------|
| On request | | | | | | | |

[Types and changes reserved]

Indication dimensions VN-Winder HT

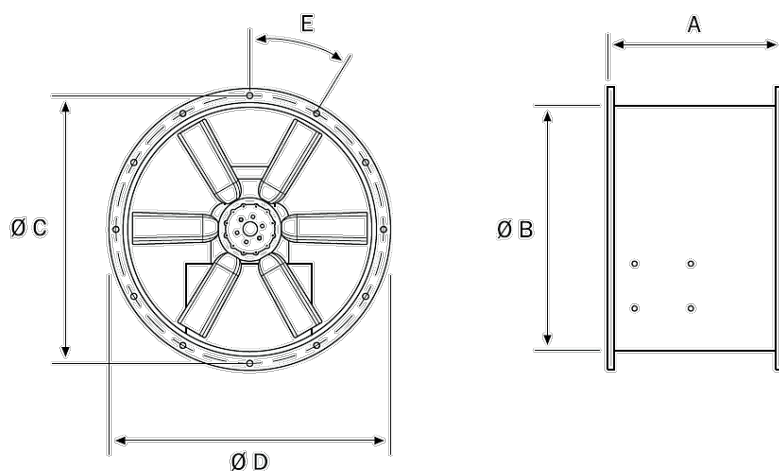

| | A | $\varnothing B$ | $\varnothing C$ | $\varnothing D$ | E |
|-----|-----|-----------------|-----------------|-----------------|-------|
| 315 | 320 | 315 | 355 | 385 | 13x45 |
| 355 | 320 | 355 | 395 | 436 | 13x45 |
| 400 | 320 | 410 | 451 | 486 | 8x45 |
| 450 | 350 | 460 | 500 | 536 | 8x45 |
| 500 | 400 | 510 | 552 | 588 | 12x30 |

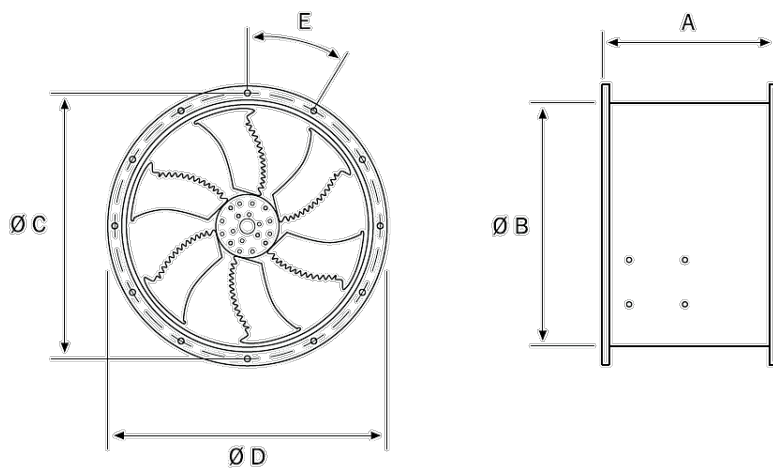

| | A | $\varnothing B$ | $\varnothing C$ | $\varnothing D$ | E |
|------|-----|-----------------|-----------------|-----------------|---------|
| 560 | 400 | 565 | 620 | 648 | 12x30 |
| 630 | 400 | 640 | 690 | 720 | 12x30 |
| 710 | 500 | 720 | 770 | 800 | 12x30 |
| 800 | 600 | 807 | 860 | 900 | 16x22,5 |
| 900 | 700 | 910 | 970 | 1010 | 16x22,5 |
| 1000 | 700 | 1010 | 1070 | 1110 | 16x22,5 |
| 1250 | 900 | 1265 | 1315 | 1355 | 16x22,5 |
| 1400 | 900 | 1400 | 1470 | 1530 | 16x22,5 |
| 1600 | 900 | 1600 | 1680 | 1740 | 24x15 |